

SERVICE MANUAL

DVD PLAYER

BASIC DVD/CD MECHANISM : DV32BF

ACCESSORIES LIST

REF. NO	PART NO.	KANRI NO.	DESCRIPTION
1	8A-AV6-910-010		IB,HR (E/CK/CH) -DV170<HR(S)>
1	8A-AV6-911-010		IB,LH (ESP) -DV170<LH(S)>
1	8A-AV6-906-010		IB,K (E) -DV170<K(S)>
1	8A-AV6-907-010		IB,EZ (9L) -DV170<Z(S)>
2	8A-AV6-620-010		RC UNIT,RC-AVL01<EXCEPT HR(S)>
	2	8A-AV6-622-010	RC UNIT,RC-AVL06<HR(S)>
⚠	3	87-B30-415-010	AC ADAPTOR,AC-D1003ENC
⚠	3	87-050-076-010	AC CORD SET ASSY,E
⚠	3	87-AV1-641-010	ADAPTOR,RGB-RCA YKS11-0027<K(S),Z(S)>
	4	87-050-052-010	CORD,PIN 1.5M Y/W/R 3P
⚠	5	87-A91-017-010	PLUG,CONVERSION JT-0476<HR(S),LH(S)>
⚠	5	87-099-726-010	PLUG,ADPTR CONV(K)<K(S)>

PROTECTION OF EYES FROM LASER BEAM DURING SERVICING

This set employs laser. Therefore, be sure to follow carefully the instructions below when servicing.

WARNING!

WHEN SERVICING, DO NOT APPROACH THE LASER EXIT WITH THE EYE TOO CLOSELY. IN CASE IT IS NECESSARY TO CONFIRM LASER BEAM EMISSION. BE SURE TO OBSERVE FROM A DISTANCE OF MORE THAN 30cm FROM THE SURFACE OF THE OBJECTIVE LENS ON THE OPTICAL PICK-UP BLOCK.

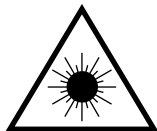

- Caution: Invisible laser radiation when open and interlocks defeated avoid exposure to beam.
- Advarsel: Usynlig laserstråling ved åbning, når sikkerhedsafbrydere er ude af funktion. Undgå udsættelse for stråling.

VAROITUS!

Laitteen Käyttöminen muulla kuin tässä käyttöohjeessa mainitulla tavalla saattaa altistaa käyttäjän turvallisuusluokan 1 ylittävälle näkyvälle lasersäteilylle.

WARNING!

Om apparaten används på annat sätt än vad som specificeras i denna bruksanvisning, kan användaren utsättas för osynlig laserstråling, som verskrider gränsen för laserklass 1.

Precaution to replace Optical block

Body or clothes electrostatic potential could ruin laser diode in the optical block. Be sure ground body and workbench, and use care the clothes do not touch the diode.

- 1) After the connection, remove solder shown in the figures below.

CAUTION

Use of controls or adjustments or performance of procedures other than those specified herein may result in hazardous radiation exposure.

ATTENTION

L'utilisation de commandes, réglages ou procédures autres que ceux spécifiés peut entraîner une dangereuse exposition aux radiations.

ADVARSEL!

Usynlig laserstråling ved åbning, når sikkerhedsafbrydere er ude af funktion. Undgå udsættelse for stråling.

This Compact Disc player is classified as a CLASS 1 LASER product.

The CLASS 1 LASER PRODUCT label is located on the rear exterior.

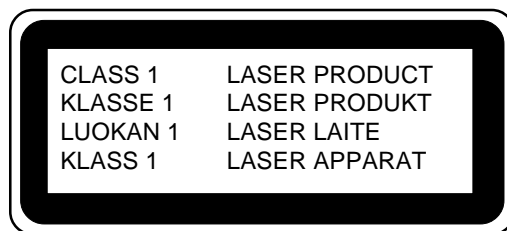

(SF-HD3AV/HD3AVC)

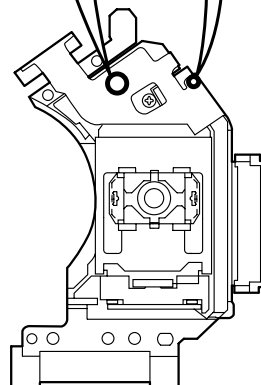
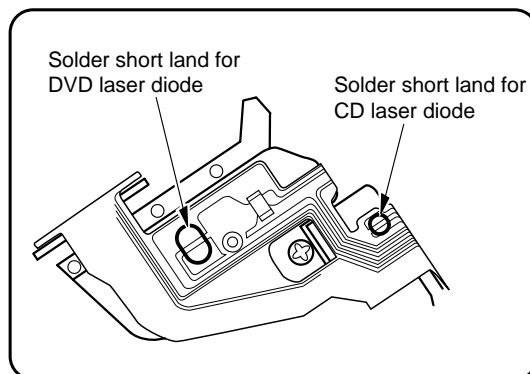

ELECTRICAL MAIN PARTS LIST

REF. NO	PART NO.	KANRI NO.	DESCRIPTION	REF. NO	PART NO.	KANRI NO.	DESCRIPTION
IC				C0005	87-A11-976-080		C-CAP,E 470-16 M 10.5L MV
	87-A21-032-080	C-IC,S-8520B28MC		C0006	87-A12-416-080		C-CAP,E 100U-25 M 7.7L UD
	87-A20-925-040	C-IC,BA05FP		C0007	87-016-669-080		C-CAP,S 0.1-25 K B
	87-A20-905-040	C-IC,BA033FP		C0008	87-A12-416-080		C-CAP,E 100U-25 M 7.7L UD
	87-A21-764-040	C-IC,BA00ASFP		C0009	87-016-669-080		C-CAP,S 0.1-25 K B
	87-A20-080-040	C-IC,TC74HC14AF		C0010	87-012-286-080		C-CAP,U 0.01-25 K B
	87-017-027-040	C-IC,TC7W08F		C0012	87-A11-282-080		C-CAP,S 1-16 K B
	8A-ZA7-804-010	C-IC,LC87F72C8A		C0015	87-A11-282-080		C-CAP,S 1-16 K B
	87-A21-697-040	C-IC,TC7SHU04F		C0016	87-010-831-080		C-CAP,U 0.1-16 Z F
	8A-ZA7-803-010	C-IC,LC78660W		C0017	87-A11-976-080		C-CAP,E 470-16 M 10.5L MV
	8A-ZA7-802-040	C-IC,LC324265AT-25DV		C0018	87-010-831-080		C-CAP,U 0.1-16 Z F
	87-A21-309-040	C-IC,HD74LV74A		C0019	87-A11-976-080		C-CAP,E 470-16 M 10.5L MV
	8A-ZA7-800-010	C-IC,LA9702W-MPB		C0020	87-A11-282-080		C-CAP,S 1-16 K B
	87-017-917-080	C-IC,BU4066BCF		C0021	87-010-831-080		C-CAP,U 0.1-16 Z F
	8A-ZA7-801-040	C-IC,LA6556L-TE-L		C0022	87-A11-976-080		C-CAP,E 470-16 M 10.5L MV
	88-KT1-608-010	C-IC,LC75854W		C0023	87-010-831-080		C-CAP,U 0.1-16 Z F
	87-A21-245-010	IC,RPM6938-V4		C0024	87-A11-976-080		C-CAP,E 470-16 M 10.5L MV
	87-017-853-040	C-IC,NJM2100V<HR>		C0026	87-010-831-080		C-CAP,U 0.1-16 Z F
	8A-ZA7-602-040	C-IC,HN58X2416FPI		C0027	87-A11-976-080		C-CAP,E 470-16 M 10.5L MV
	8Z-AV2-628-010	C-IC,HD6412350F20		C0028	87-010-831-080		C-CAP,U 0.1-16 Z F
	87-A20-185-040	C-IC,PST600DMT		C0029	87-A11-976-080		C-CAP,E 470-16 M 10.5L MV
	87-001-551-080	C-IC,TC7S08F		C0100	87-012-274-080		C-CAP,U 1000P-50 K B
	8A-AV6-626-010	IC,P-ROMAAV-6 (3) <HR>		C0101	87-016-428-080		C-CAP,E 47-16 M 5.5L WX
	8A-AV6-625-010	IC,P-ROMAAV-6 (E) <K,EZ>		C0102	87-010-831-080		C-CAP,U 0.1-16 Z F
	8A-AV6-628-010	IC,P-ROMAAV-6 (VER. 17B) <LH>		C0103	87-010-831-080		C-CAP,U 0.1-16 Z F
	8A-AV6-605-030	C-IC,UT611024LC-12		C0104	87-012-180-080		C-CAP,U 22P-50 J CH
	87-A20-957-040	C-IC,SN74LV245APW		C0105	87-012-180-080		C-CAP,U 22P-50 J CH
	87-A21-755-040	C-IC,SN74LV541APW		C0106	87-010-831-080		C-CAP,U 0.1-16 Z F
	8Z-AV2-630-010	C-IC,L64021D		C0107	87-016-428-080		C-CAP,E 47-16 M 5.5L WX
	87-A21-617-010	C-IC,HY57V161610DTC-8		C0108	87-010-831-080		C-CAP,U 0.1-16 Z F
	87-A20-689-080	C-IC,PCM1723		C0109	87-016-428-080		C-CAP,E 47-16 M 5.5L WX
	87-A21-613-040	C-IC,SN74LV04APW		C0110	87-010-831-080		C-CAP,U 0.1-16 Z F
	87-A21-362-040	C-IC,NJM2100M (TE2)		C0111	87-012-195-080		C-CAP,U 100P-50 J CH
	87-017-585-080	C-IC,NJM4580E<LH,K,EZ>		C0112	87-010-831-080		C-CAP,U 0.1-16 Z F
	87-A21-103-040	C-IC,MM1454XFBE		C0113	87-010-848-080		C-CAP,E 10-16 M 5.5L MV
	8A-AV6-614-040	C-IC,YSS915C-PK28MP-1<HR>		C0114	87-010-848-080		C-CAP,E 10-16 M 5.5L MV
	87-A21-754-010	C-IC,MC44722AVFU		C0115	87-010-831-080		C-CAP,U 0.1-16 Z F
	87-A20-582-010	IC,GP1F31TJ		C0116	87-012-172-080		C-CAP,U 10P-50 D CH
	87-017-453-080	C-IC,NJM2267M		C0117	87-012-172-080		C-CAP,U 10P-50 D CH
	87-017-750-080	C-IC,MM1041XM		C0118	87-012-172-080		C-CAP,U 10P-50 D CH
TRANSISTOR				C0119	87-012-172-080		C-CAP,U 10P-50 D CH
	87-A30-382-040	C-FET,FTS1002		C0120	87-012-172-080		C-CAP,U 10P-50 D CH
	89-110-372-080	C-TR,2SA1037K (R)		C0121	87-012-172-080		C-CAP,U 10P-50 D CH
	89-211-323-080	C-TR,2SB1132R		C0122	87-012-172-080		C-CAP,U 10P-50 D CH
	89-333-265-040	C-TR,2SC3326A		C0123	87-012-172-080		C-CAP,U 10P-50 D CH
	87-A30-516-040	C-FET,3LN01C-TB		C0124	87-012-172-080		C-CAP,U 10P-50 D CH
	87-026-210-080	C-TR,DTC144EK		C0125	87-012-172-080		C-CAP,U 10P-50 D CH
	89-341-165-080	C-TR,2SC4116GR		C0126	87-012-286-080		C-CAP,U 0.01-25 K B
	89-115-864-080	C-TR,2SA1586Y		C0127	87-012-286-080		C-CAP,U 0.01-25 K B
	89-333-265-080	C-TR,2SC3326A<HR>		C0128	87-012-286-080		C-CAP,U 0.01-25 K B
	87-026-227-080	C-TR,DTA114EK		C0129	87-012-286-080		C-CAP,U 0.01-25 K B
	87-026-342-080	C-TR,DTC144EU		C0130	87-012-286-080		C-CAP,U 0.01-25 K B
	89-342-132-080	C-TR,2SC4213B		C0201	87-010-831-080		C-CAP,U 0.1-16 Z F
	87-026-211-080	C-TR,DTA144EK		C0202	87-A11-031-080		C-CAP,E 100-16 M WX
	89-324-123-080	C-TR,2SC2412KS		C0203	87-010-831-080		C-CAP,U 0.1-16 Z F
DIODE				C0205	87-010-831-080		C-CAP,U 0.1-16 Z F
	87-017-779-080	C-DIODE,1SS355		C0206	87-A11-031-080		C-CAP,E 100-16 M WX
	87-017-990-080	C-DIODE,U2FWJ44N		C0208	87-016-430-080		C-CAP,E 100-6.3 M 5.5L WX
	87-A40-797-040	C-DIODE,SBE001		C0209	87-016-427-080		C-CAP,E 47-6.3 M 5.5L WX
	87-001-166-080	C-DIODE,1SS301		C0211	87-010-831-080		C-CAP,U 0.1-16 Z F
	87-001-165-080	C-DIODE,1SS300		C0217	87-010-831-080		C-CAP,U 0.1-16 Z F
				C0218	87-010-831-080		C-CAP,U 0.1-16 Z F
				C0219	87-A12-344-080		C-CAP,E 100-6.3 VC PX
				C0220	87-012-274-080		C-CAP,U 1000P-50 K B
				C0221	87-012-274-080		C-CAP,U 1000P-50 K B
MAIN C.B				C0222	87-010-831-080		C-CAP,U 0.1-16 Z F
C0002	87-016-669-080	C-CAP,S 0.1-25 K B		C0224	87-012-277-080		C-CAP,U 1800P-50 K B GRM
C0003	87-010-831-080	C-CAP,U 0.1-16 Z F		C0225	87-012-274-080		C-CAP,U 1000P-50 K B
				C0226	87-012-274-080		C-CAP,U 1000P-50 K B
				C0227	87-012-274-080		C-CAP,U 1000P-50 K B

REF. NO	PART NO.	KANRI NO.	DESCRIPTION	REF. NO	PART NO.	KANRI NO.	DESCRIPTION
C0228	87-012-274-080	C-CAP,U	1000P-50 K B	C0347	87-012-165-080	C-CAP,U	3P-50 C CH
C0229	87-012-274-080	C-CAP,U	1000P-50 K B	C0348	87-010-831-080	C-CAP,U	0.1-16 Z F
C0231	87-012-274-080	C-CAP,U	1000P-50 K B	C0349	87-010-843-080	C-CAP,E	1-50 M 5.5L MV
C0232	87-012-274-080	C-CAP,U	1000P-50 K B	C0350	87-010-831-080	C-CAP,U	0.1-16 Z F
C0233	87-010-831-080	C-CAP,U	0.1-16 Z F	C0351	87-010-831-080	C-CAP,U	0.1-16 Z F
C0234	87-010-831-080	C-CAP,U	0.1-16 Z F	C0352	87-016-427-080	C-CAP,E	47-6.3 M 5.5L WX
C0235	87-012-174-080	C-CAP,U	12P-50 J CH	C0353	87-016-427-080	C-CAP,E	47-6.3 M 5.5L WX
C0236	87-012-174-080	C-CAP,U	12P-50 J CH	C0354	87-012-164-080	C-CAP,U	2P-50 C CH
C0237	87-010-831-080	C-CAP,U	0.1-16 Z F	C0355	87-A11-031-080	C-CAP,E	100-16 M WX
C0238	87-010-829-080	C-CAP,U	0.047-16 Z F	C0356	87-012-176-080	C-CAP,U	15P-50 J CH
C0239	87-010-829-080	C-CAP,U	0.047-16 Z F	C0357	87-010-831-080	C-CAP,U	0.1-16 Z F
C0240	87-010-831-080	C-CAP,U	0.1-16 Z F	C0358	87-012-274-080	C-CAP,U	1000P-50 K B
C0241	87-010-831-080	C-CAP,U	0.1-16 Z F	C0359	87-012-274-080	C-CAP,U	1000P-50 K B
C0242	87-012-286-080	C-CAP,U	0.01-25 K B	C0400	87-010-831-080	C-CAP,U	0.1-16 Z F
C0243	87-012-197-080	C-CAP,U	150P-50 J CH	C0401	87-016-427-080	C-CAP,E	47-6.3 M 5.5L WX
C0244	87-010-831-080	C-CAP,U	0.1-16 Z F	C0402	87-010-831-080	C-CAP,U	0.1-16 Z F
C0245	87-010-831-080	C-CAP,U	0.1-16 Z F	C0403	87-010-831-080	C-CAP,U	0.1-16 Z F
C0246	87-010-831-080	C-CAP,U	0.1-16 Z F	C0404	87-A11-968-080	C-CAP,E	220-16 M UR
C0247	87-010-831-080	C-CAP,U	0.1-16 Z F	C0405	87-010-831-080	C-CAP,U	0.1-16 Z F
C0248	87-010-831-080	C-CAP,U	0.1-16 Z F	C0406	87-010-831-080	C-CAP,U	0.1-16 Z F
C0249	87-010-831-080	C-CAP,U	0.1-16 Z F	C0407	87-012-199-080	C-CAP,U	220P-50 J CH
C0250	87-010-831-080	C-CAP,U	0.1-16 Z F	C0408	87-012-199-080	C-CAP,U	220P-50 J CH
C0251	87-010-831-080	C-CAP,U	0.1-16 Z F	C0409	87-012-199-080	C-CAP,U	220P-50 J CH
C0252	87-010-831-080	C-CAP,U	0.1-16 Z F	C0410	87-012-199-080	C-CAP,U	220P-50 J CH
C0253	87-010-831-080	C-CAP,U	0.1-16 Z F	C0424	87-010-848-080	C-CAP,E	10-16 M 5.5L MV
C0254	87-010-831-080	C-CAP,U	0.1-16 Z F	C0425	87-010-831-080	C-CAP,U	0.1-16 Z F
C0255	87-010-831-080	C-CAP,U	0.1-16 Z F	C0426	87-010-831-080	C-CAP,U	0.1-16 Z F
C0256	87-012-282-080	C-CAP,U	4700P-50 K B	C0427	87-010-848-080	C-CAP,E	10-16 M 5.5L MV
C0257	87-016-427-080	C-CAP,E	47-6.3 M 5.5L WX	C0601	87-012-286-080	C-CAP,U	0.01-25 K B
C0259	87-016-427-080	C-CAP,E	47-6.3 M 5.5L WX	C0602	87-012-286-080	C-CAP,U	0.01-25 K B
C0260	87-012-286-080	C-CAP,U	0.01-25 K B	C0604	87-012-286-080	C-CAP,U	0.01-25 K B
C0261	87-012-286-080	C-CAP,U	0.01-25 K B	C0605	87-012-286-080	C-CAP,U	0.01-25 K B
C0300	87-016-427-080	C-CAP,E	47-6.3 M 5.5L WX	C0608	87-016-428-080	C-CAP,E	47-16 M 5.5L WX
C0301	87-016-427-080	C-CAP,E	47-6.3 M 5.5L WX	C0609	87-012-286-080	C-CAP,U	0.01-25 K B
C0302	87-010-831-080	C-CAP,U	0.1-16 Z F	C0612	87-012-286-080	C-CAP,U	0.01-25 K B
C0303	87-010-831-080	C-CAP,U	0.1-16 Z F	C0613	87-012-286-080	C-CAP,U	0.01-25 K B
C0304	87-012-274-080	C-CAP,U	1000P-50 K B	C0614	87-012-172-080	C-CAP,U	10P-50 D CH
C0305	87-016-428-080	C-CAP,E	47-16 M 5.5L WX	C0615	87-016-428-080	C-CAP,E	47-16 M 5.5L WX
C0307	87-012-274-080	C-CAP,U	1000P-50 K B	C0617	87-012-172-080	C-CAP,U	10P-50 D CH
C0308	87-016-428-080	C-CAP,E	47-16 M 5.5L WX	C0619	87-012-286-080	C-CAP,U	0.01-25 K B
C0311	87-010-831-080	C-CAP,U	0.1-16 Z F	C0620	87-012-286-080	C-CAP,U	0.01-25 K B
C0312	87-012-271-080	C-CAP,U	560P-50 K B	C0623	87-012-286-080	C-CAP,U	0.01-25 K B
C0313	87-012-271-080	C-CAP,U	560P-50 K B	C0624	87-012-286-080	C-CAP,U	0.01-25 K B
C0314	87-012-271-080	C-CAP,U	560P-50 K B	C0625	87-010-848-080	C-CAP,E	10-16 M 5.5L MV
C0315	87-012-271-080	C-CAP,U	560P-50 K B	C0626	87-012-286-080	C-CAP,U	0.01-25 K B
C0316	87-012-271-080	C-CAP,U	560P-50 K B	C0627	87-012-286-080	C-CAP,U	0.01-25 K B
C0317	87-012-282-080	C-CAP,U	4700P-50 K B	C0628	87-012-286-080	C-CAP,U	0.01-25 K B
C0318	87-012-271-080	C-CAP,U	560P-50 K B	C0630	87-010-848-080	C-CAP,E	10-16 M 5.5L MV
C0319	87-012-196-080	C-CAP,U	120P-50 J CH	C0632	87-010-848-080	C-CAP,E	10-16 M 5.5L MV
C0320	87-A11-031-080	C-CAP,E	100-16 M WX	C0634	87-012-286-080	C-CAP,U	0.01-25 K B
C0321	87-010-831-080	C-CAP,U	0.1-16 Z F	C0639	87-010-848-080	C-CAP,E	10-16 M 5.5L MV
C0322	87-012-196-080	C-CAP,U	120P-50 J CH	C0640	87-012-286-080	C-CAP,U	0.01-25 K B
C0323	87-010-831-080	C-CAP,U	0.1-16 Z F	C0641	87-012-286-080	C-CAP,U	0.01-25 K B
C0324	87-012-197-080	C-CAP,U	150P-50 J CH	C0642	87-012-286-080	C-CAP,U	0.01-25 K B
C0330	87-012-184-080	C-CAP,U	33P-50 J CH	C0643	87-010-197-080	C-CAP,S	0.01-25 K B C2012<K,EZ>
C0332	87-012-197-080	C-CAP,U	150P-50 J CH	C0702	87-016-428-080	C-CAP,E	47-16 M 5.5L WX
C0333	87-012-184-080	C-CAP,U	33P-50 J CH	C0703	87-A11-031-080	C-CAP,E	100-16 M WX
C0334	87-012-191-080	C-CAP,U	68P-50 J CH	C0704	87-012-286-080	C-CAP,U	0.01-25 K B
C0335	87-012-199-080	C-CAP,U	220P-50 J CH	C0705	87-012-286-080	C-CAP,U	0.01-25 K B
C0336	87-012-197-080	C-CAP,U	150P-50 J CH	C0706	87-012-286-080	C-CAP,U	0.01-25 K B
C0337	87-012-188-080	C-CAP,U	47P-50 J CH	C0707	87-012-278-080	C-CAP,U	2200P-50 K B
C0338	87-012-174-080	C-CAP,U	12P-50 J CH	C0708	87-012-286-080	C-CAP,U	0.01-25 K B
C0339	87-012-195-080	C-CAP,U	100P-50 J CH	C0709	87-012-286-080	C-CAP,U	0.01-25 K B
C0340	87-016-428-080	C-CAP,E	47-16 M 5.5L WX	C0710	87-016-428-080	C-CAP,E	47-16 M 5.5L WX
C0341	87-012-193-080	C-CAP,U	82P-50 J CH	C0711	87-012-286-080	C-CAP,U	0.01-25 K B
C0342	87-012-180-080	C-CAP,U	22P-50 J CH	C0712	87-012-286-080	C-CAP,U	0.01-25 K B
C0343	87-012-270-080	C-CAP,U	470P-50 K B	C0713	87-012-286-080	C-CAP,U	0.01-25 K B
C0344	87-012-195-080	C-CAP,U	100P-50 J CH	C0714	87-012-286-080	C-CAP,U	0.01-25 K B
C0345	87-012-197-080	C-CAP,U	150P-50 J CH	C0715	87-012-286-080	C-CAP,U	0.01-25 K B
C0346	87-012-196-080	C-CAP,U	120P-50 J CH	C0716	87-012-286-080	C-CAP,U	0.01-25 K B

REF. NO	PART NO.	KANRI NO.	DESCRIPTION	REF. NO	PART NO.	KANRI NO.	DESCRIPTION
C0717	87-012-286-080	C-CAP,U	0.01-25 K B	C0950	87-012-286-080	C-CAP,U	0.01-25 K B
C0718	87-012-286-080	C-CAP,U	0.01-25 K B	C0951	87-010-848-080	C-CAP,E	10-16 M 5.5L MV
C0719	87-012-286-080	C-CAP,U	0.01-25 K B	C0952	87-010-846-080	C-CAP,E	4.7-35 M 5.5L MV
C0720	87-012-286-080	C-CAP,U	0.01-25 K B	C0953	87-A11-974-080	C-CAP,E	22-16 M 5.5L MV
C0721	87-012-286-080	C-CAP,U	0.01-25 K B	C0954	87-A11-031-080	C-CAP,E	100-16 M WX
C0722	87-012-286-080	C-CAP,U	0.01-25 K B	C0955	87-012-286-080	C-CAP,U	0.01-25 K B
C0723	87-012-286-080	C-CAP,U	0.01-25 K B	C0956	87-010-846-080	C-CAP,E	4.7-35 M 5.5L MV
C0724	87-012-286-080	C-CAP,U	0.01-25 K B	C0957	87-A11-974-080	C-CAP,E	22-16 M 5.5L MV
C0725	87-012-170-080	C-CAP,U	8P-50 D CH	C0958	87-A11-031-080	C-CAP,E	100-16 M WX
C0726	87-012-196-080	C-CAP,U	120P-50 J CH	C0959	87-012-286-080	C-CAP,U	0.01-25 K B
C0730	87-010-831-080	C-CAP,U	0.1-16 Z F<HR>	C0960	87-012-286-080	C-CAP,U	0.01-25 K B
C0731	87-010-848-080	C-CAP,E	10-16 M 5.5L MV	C0961	87-010-831-080	C-CAP,U	0.1-16 Z F
C0732	87-012-286-080	C-CAP,U	0.01-25 K B	CN0100	87-A61-476-080	C-CONN,10P V WHT	BM10B-SRSS-TB
C0733	87-012-196-080	C-CAP,U	120P-50 J CH	CN0300	87-A61-459-080	C-CONN,33P H	XF2H-3315-1
C0734	87-012-170-080	C-CAP,U	8P-50 D CH	CN0402	87-A61-337-080	C-CONN,9P V WHT	PH-SM3-TB
C0735	87-012-286-080	C-CAP,U	0.01-25 K B	CN0600	87-009-984-080	C-CONN,2P V WHT	ZR
C0736	87-010-848-080	C-CAP,E	10-16 M 5.5L MV	CN0601	87-A60-777-010	CONN,14P B	TMC-D(P)
C0737	87-010-848-080	C-CAP,E	10-16 M 5.5L MV	CN0700	87-099-578-080	C-CONN,4P V	ZH-SM3<HR>
C0738	87-012-196-080	C-CAP,U	120P-50 J CH	CNA0402	8A-ZGD-607-010	CONN ASSY,9P	PH
C0739	87-010-831-080	C-CAP,U	0.1-16 Z F<HR>	CNA0601	8A-AV6-617-010	CONN ASSY,2P V WHT	LID (CHINA)<HR, LH>
C0741	87-010-831-080	C-CAP,U	0.1-16 Z F	CNA0601	8A-AV6-618-010	CONN ASSY,2P V WHT	LID U (CHIN<K,EZ>
C0744	87-010-831-080	C-CAP,U	0.1-16 Z F	CNA0700	8A-AV6-615-010	CONN ASSY,4P ZR	KARAOKE<HR>
C0745	87-010-831-080	C-CAP,U	0.1-16 Z F	FB0001	87-A91-720-080	C-F-BEAD, FBMJ3216HS800-T	
C0759	87-010-848-080	C-CAP,E	10-16 M 5.5L MV	FB0002	87-A91-720-080	C-F-BEAD, FBMJ3216HS800-T	
C0760	87-010-848-080	C-CAP,E	10-16 M 5.5L MV	FB0003	87-A91-720-080	C-F-BEAD, FBMJ3216HS800-T	
C0771	87-012-278-080	C-CAP,U	2200P-50 K B	FB0005	87-A91-720-080	C-F-BEAD, FBMJ3216HS800-T	
C0772	87-012-278-080	C-CAP,U	2200P-50 K B	FB0006	87-A91-720-080	C-F-BEAD, FBMJ3216HS800-T	
C0773	87-012-279-080	C-CAP,U	2700P-50 K B GRM	FB0007	87-A91-720-080	C-F-BEAD, FBMJ3216HS800-T	
C0774	87-012-279-080	C-CAP,U	2700P-50 K B GRM	FB0008	87-A91-720-080	C-F-BEAD, FBMJ3216HS800-T	
C0775	87-012-267-080	C-CAP,U	270P-50 K B GRM	FB0201	87-A91-720-080	C-F-BEAD, FBMJ3216HS800-T	
C0776	87-012-267-080	C-CAP,U	270P-50 K B GRM	FB0731	87-A91-480-080	C-F-BEAD, BK1608	HS121
C0777	87-010-458-080	C-CAP,E	2.2-50 M MV	FB0737	87-A91-480-080	C-F-BEAD, BK1608	HS121
C0778	87-010-458-080	C-CAP,E	2.2-50 M MV	FB0739	87-A91-480-080	C-F-BEAD, BK1608	HS121
C0779	87-A11-974-080	C-CAP,E	22-16 M 5.5L MV	FFC0001	8A-AV6-607-010	FLEX-PWB,33P	RF
C0780	87-A11-974-080	C-CAP,E	22-16 M 5.5L MV	J0001	87-A61-165-010	JACK,DC	4.75 BLK 10.5
C0781	87-012-186-080	C-CAP,U	39P-50 J CH	J0606	87-A61-145-010	C-SOCKET,IC	2-44P IC179-44600
C0782	87-012-186-080	C-CAP,U	39P-50 J CH	J0950	87-A60-127-010	JACK,Y/CYKF51-5503	
C0783	87-010-848-080	C-CAP,E	10-16 M 5.5L MV	J0951	87-A61-473-010	JACK,PIN	3P WHT YKC21-5816
C0784	87-010-831-080	C-CAP,U	0.1-16 Z F	L0003	87-A50-545-080	C-COIL,47UH-D124C	
C0785	87-010-831-080	C-CAP,U	0.1-16 Z F	L0004	84-HD1-620-080	C-COIL, 22UH	M D75C
C0786	87-010-848-080	C-CAP,E	10-16 M 5.5L MV	L0005	87-A50-395-080	C-COIL,100UHD73C-636CY	
C0787	87-010-831-080	C-CAP,U	0.1-16 Z F	L0006	87-A50-395-080	C-COIL,100UHD73C-636CY	
C0788	87-010-831-080	C-CAP,U	0.1-16 Z F	L0100	87-A50-667-080	C-COIL, 1.0UH	K FLC32
C0789	87-010-848-080	C-CAP,E	10-16 M 5.5L MV	L0201	87-A50-395-080	C-COIL,100UHD73C-636CY	
C0790	87-010-848-080	C-CAP,E	10-16 M 5.5L MV	L0202	87-A91-720-080	C-F-BEAD, FBMJ3216HS800-T	
C0791	87-012-195-080	C-CAP,U	100P-50 J CH	L0203	87-A50-668-080	C-COIL, 2.2UH	K FLC32
C0792	87-016-428-080	C-CAP,E	47-16 M 5.5L WX	L0300	87-A50-395-080	C-COIL,100UHD73C-636CY	
C0793	87-012-286-080	C-CAP,U	0.01-25 K B	L0301	87-005-811-080	C-COIL, 10UH	FLC32
C0794	87-012-286-080	C-CAP,U	0.01-25 K B	L0302	87-005-811-080	C-COIL, 10UH	FLC32
C0795	87-A11-974-080	C-CAP,E	22-16 M 5.5L MV	L0400	87-A50-667-080	C-COIL, 1.0UH	K FLC32
C0800	87-012-286-080	C-CAP,U	0.01-25 K B	L0600	87-A50-667-080	C-COIL, 1.0UH	K FLC32
C0801	87-016-428-080	C-CAP,E	47-16 M 5.5L WX	L0601	87-A50-667-080	C-COIL, 1.0UH	K FLC32
C0802	87-016-428-080	C-CAP,E	47-16 M 5.5L WX	L0602	87-A50-667-080	C-COIL, 1.0UH	K FLC32
C0803	87-010-831-080	C-CAP,U	0.1-16 Z F	L0603	87-A50-667-080	C-COIL, 1.0UH	K FLC32
C0804	87-010-831-080	C-CAP,U	0.1-16 Z F	L0700	87-A50-667-080	C-COIL, 1.0UH	K FLC32
C0806	87-010-831-080	C-CAP,U	0.1-16 Z F	L0701	87-A50-667-080	C-COIL, 1.0UH	K FLC32
C0810	87-012-286-080	C-CAP,U	0.01-25 K B	L0702	87-A50-668-080	C-COIL, 2.2UH	K FLC32
C0811	87-016-428-080	C-CAP,E	47-16 M 5.5L WX	L0704	87-A50-668-080	C-COIL, 2.2UH	K FLC32
C0812	87-012-286-080	C-CAP,U	0.01-25 K B	L0705	87-005-815-080	C-COIL, 22UH	J FLC32
C0817	87-010-848-080	C-CAP,E	10-16 M 5.5L MV	L0800	87-A50-668-080	C-COIL, 2.2UH	K FLC32
C0818	87-012-286-080	C-CAP,U	0.01-25 K B	L0801	87-005-815-080	C-COIL, 22UH	J FLC32
C0819	87-012-186-080	C-CAP,U	39P-50 J CH	L0802	87-005-811-080	C-COIL, 10UH	FLC32
C0820	87-012-182-080	C-CAP,U	27P-50 J CH	L0803	87-005-817-080	C-COIL, 33UH	J FLC32
C0834	87-012-184-080	C-CAP,U	33P-50 J CH	L0805	87-005-816-080	C-COIL, 27UH	J FLC32
C0835	87-012-174-080	C-CAP,U	12P-50 J CH	L0806	87-005-816-080	C-COIL, 27UH	J FLC32
C0836	87-012-178-080	C-CAP,U	18P-50 J CH	L0810	87-005-816-080	C-COIL, 27UH	J FLC32
C0837	87-012-184-080	C-CAP,U	33P-50 J CH	L0811	87-005-816-080	C-COIL, 27UH	J FLC32
C0838	87-012-174-080	C-CAP,U	12P-50 J CH	L0950	87-005-815-080	C-COIL, 22UH	J FLC32
C0839	87-012-178-080	C-CAP,U	18P-50 J CH	R0005	87-022-247-080	C-RES,U	22K-1/16W F
C0844	87-012-168-080	C-CAP,U	6P-50 D CH	R0006	87-022-284-080	C-RES,U	68K-1/16W F

REF. NO	PART NO.	KANRI NO.	DESCRIPTION	REF. NO	PART NO.	KANRI NO.	DESCRIPTION
R0012	87-022-284-080		C-RES,U 68K-1/16W F	S0513	87-A90-164-080		SW,TACT SKQNB(N)
R0013	87-022-285-080		C-RES,U 82K-1/16W F	S0514	87-A90-164-080		SW,TACT SKQNB(N)
R0020	87-022-241-080		C-RES,U 12K-1/16W F	S0515	87-A90-164-080		SW,TACT SKQNB(N)
R0021	87-022-223-080		C-RES,U 2.2K-1/16W F				
S0950	87-A90-166-010		SW,SL SLD-12-500H<HR,K,EZ>				
X0100	87-A70-284-080		C-VIB,XTAL 10MHZ HC-49/U03C				
X0200	87-A70-283-080		C-VIB,XTAL 16.9344MHZ HC-49/U0				
X0600	87-A70-194-080		C-VIB,XTAL 20MHZ HC-49/U03C				
X0700	87-A70-195-080		C-VIB,XTAL 27MHZ HC-49/U03C				
FRONT C.B				KARAOKE C.B			
C0500	87-010-831-080		C-CAP,U 0.1-16 Z F	C0553	87-012-286-080		C-CAP,U 0.01-25 K B<HR>
C0501	87-010-831-080		C-CAP,U 0.1-16 Z F	C0554	87-010-380-080		CAP,E 47-16 M 11L SME<HR>
C0502	87-012-272-080		C-CAP,U 680P-50 K B GRM	C0555	87-010-545-080		CAP,E 0.22-50 M 11L SME<HR>
C0503	87-010-831-080		C-CAP,U 0.1-16 Z F	C0556	87-012-276-080		C-CAP,U 1500P-50 K B<HR>
C0504	87-010-498-080		CAP,E 10-16 M 5L SRE	C0557	87-010-545-080		CAP,E 0.22-50 M 11L SME<HR>
C0505	87-010-831-080		C-CAP,U 0.1-16 Z F	C0558	87-010-382-080		CAP,E 22-25 M 11L SME<HR>
C0506	87-010-498-080		CAP,E 10-16 M 5L SRE	C0559	87-010-404-080		CAP,E 4.7-50 M 11L SME<HR>
CN0500	87-A60-769-010		CONN,14P B TMC-D(X)	C0560	87-010-380-080		CAP,E 47-16 M 11L SME<HR>
L0500	87-005-184-080		COIL,1UH K EL0606	C0561	87-012-286-080		C-CAP,U 0.01-25 K B<HR>
LCD0500	8A-AV6-608-010		LCD,AAV-6	C0562	87-010-545-080		CAP,E 0.22-50 M 11L SME<HR>
LED0500	87-A40-943-010		LED,SEL6810ALF62 ORG	C0563	87-012-276-080		C-CAP,U 1500P-50 K B<HR>
LED0501	87-A40-943-010		LED,SEL6810ALF62 ORG	C0564	87-010-545-080		CAP,E 0.22-50 M 11L SME<HR>
S0500	87-A90-164-080		SW,TACT SKQNB(N)	C0566	87-010-404-080		CAP,E 4.7-50 M 11L SME<HR>
S0501	87-A90-164-080		SW,TACT SKQNB(N)	C0573	87-010-401-080		CAP,E 1-50 M 11L SME<HR>
S0502	87-A90-164-080		SW,TACT SKQNB(N)	C0580	87-012-278-080		C-CAP,U 2200P-50 K B<HR>
S0503	87-A90-164-080		SW,TACT SKQNB(N)	C0581	87-012-278-080		C-CAP,U 2200P-50 K B<HR>
S0504	87-A90-164-080		SW,TACT SKQNB(N)	C0582	87-012-273-080		C-CAP,U 820P-50 K B<HR>
S0505	87-A90-164-080		SW,TACT SKQNB(N)	C0583	87-012-273-080		C-CAP,U 820P-50 K B<HR>
S0506	87-A90-164-080		SW,TACT SKQNB(N)	CN0550	87-009-410-010		CONN,4P ZH V<HR>
S0507	87-A90-164-080		SW,TACT SKQNB(N)	J0551	87-A61-502-010		JACK,3.5 BLK MONO W/SW<HR>
S0508	87-A90-164-080		SW,TACT SKQNB(N)	J0552	87-A61-502-010		JACK,3.5 BLK MONO W/SW<HR>
S0509	87-A90-164-080		SW,TACT SKQNB(N)	L0550	87-005-440-080		COIL,47UH K FLR50<HR>
S0510	87-A90-164-080		SW,TACT SKQNB(N)	VR0571	87-A90-462-010		VR,RTRY 30KCX2 H RK14J12A0<HR>
S0511	87-A90-164-080		SW,TACT SKQNB(N)	VR0572	87-A90-462-010		VR,RTRY 30KCX2 H RK14J12A0<HR>
S0512	87-A90-164-080		SW,TACT SKQNB(N)	VR0573	87-A90-462-010		VR,RTRY 30KCX2 H RK14J12A0<HR>

○チップ抵抗部品コード/CHIP RESISTOR PART CODE

チップ抵抗部品コードの成り立ち

Chip Resistor Part Coding



A
抵抗部品コード
Resistor Code

桁表示
Figure
抵抗値
Value of resistor

チップ抵抗
Chip resistor

容量 Wattage	種類 Type	許容誤差 Tolerance	記号 Symbol	寸法/Dimensions (mm)			抵抗コード : A Resistor Code : A	
				外形/Form	L	W		t
1/16W	1005	± 5%	CJ		1.0	0.5	0.35	104
1/16W	1608	± 5%	CJ		1.6	0.8	0.45	108
1/10W	2125	± 5%	CJ		2	1.25	0.45	118
1/8W	3216	± 5%	CJ		3.2	1.6	0.55	128

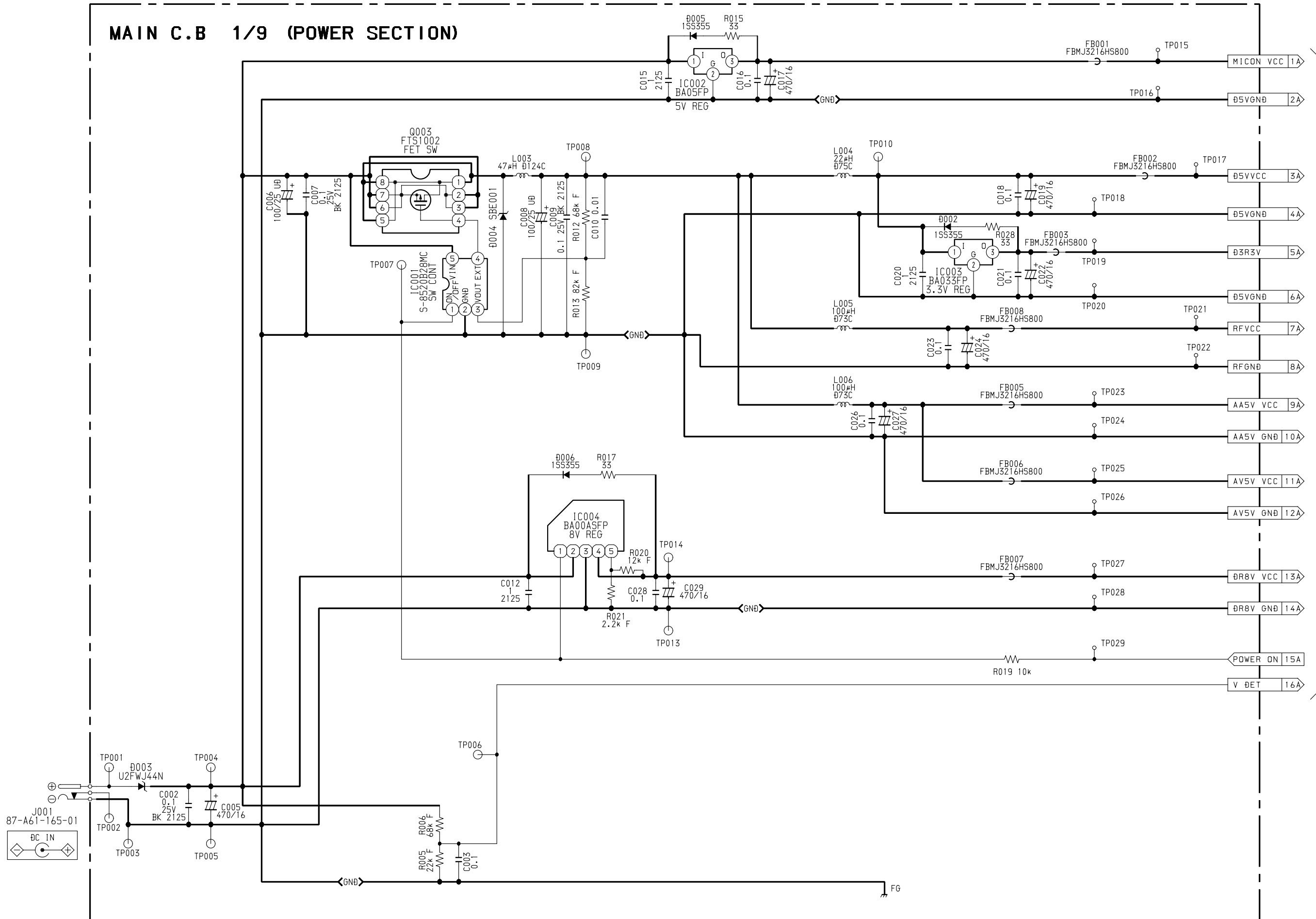

TO MCU SECTION 3A, 4A / TO 5V 5SP SECTION 3A-8A / TO RF AMP SECTION 7A, 8A /
 TO SPINDLE DRIVER SECTION 3A, 13A, 14A / TO SYSCON SECTION 1A-4A, 15A, 16A / TO AV DECODER SECTION 3A, 4A, 9A, 10A /
 TO VIDEO ENCODER SECTION 11A, 12A / TO VIDEO SECTION 3A, 4A, 12A

SCHEMATIC DIAGRAM - 2 (MAIN C.B -2/9)

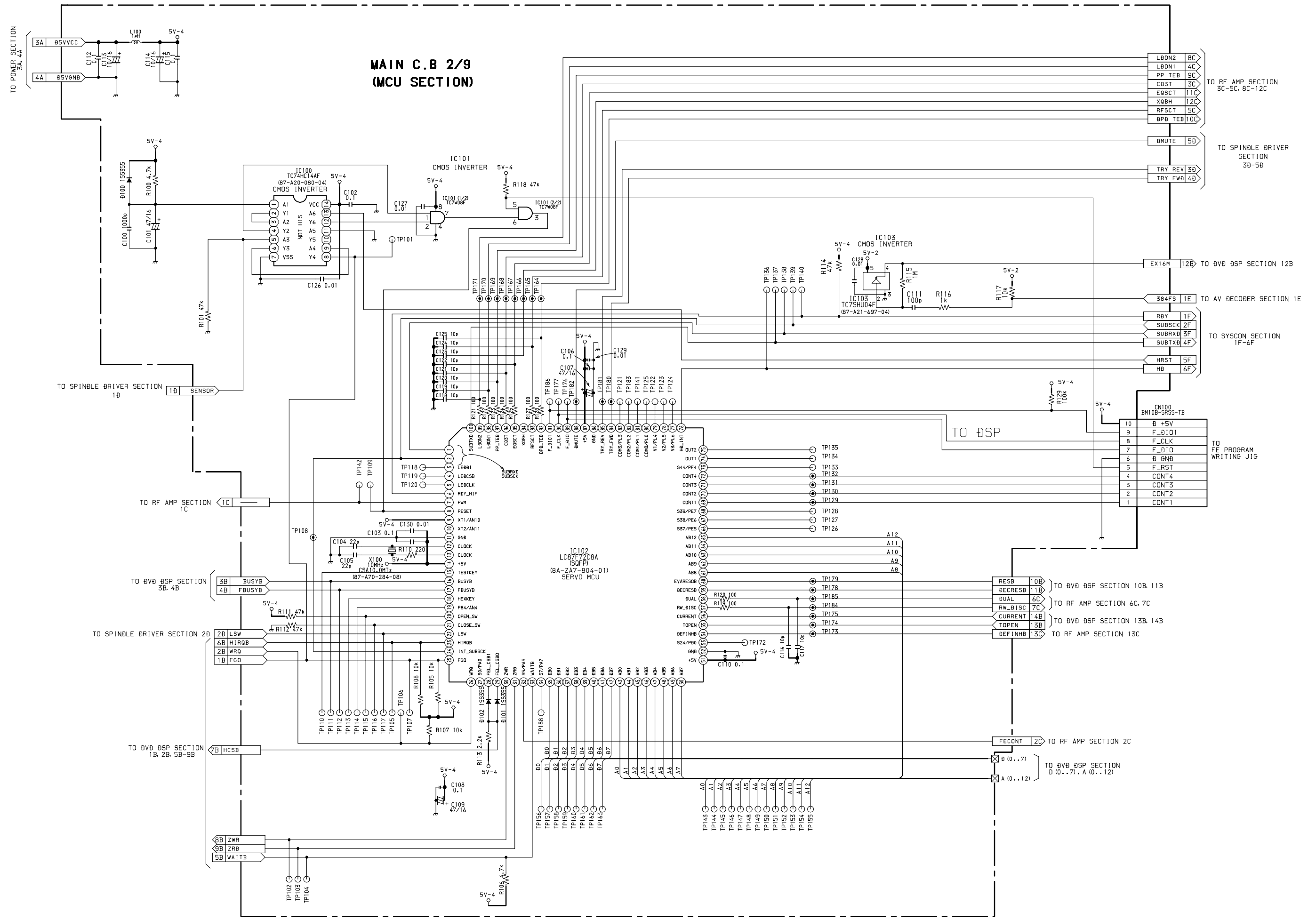

SCHEMATIC DIAGRAM - 3 (MAIN C.B 3/9)

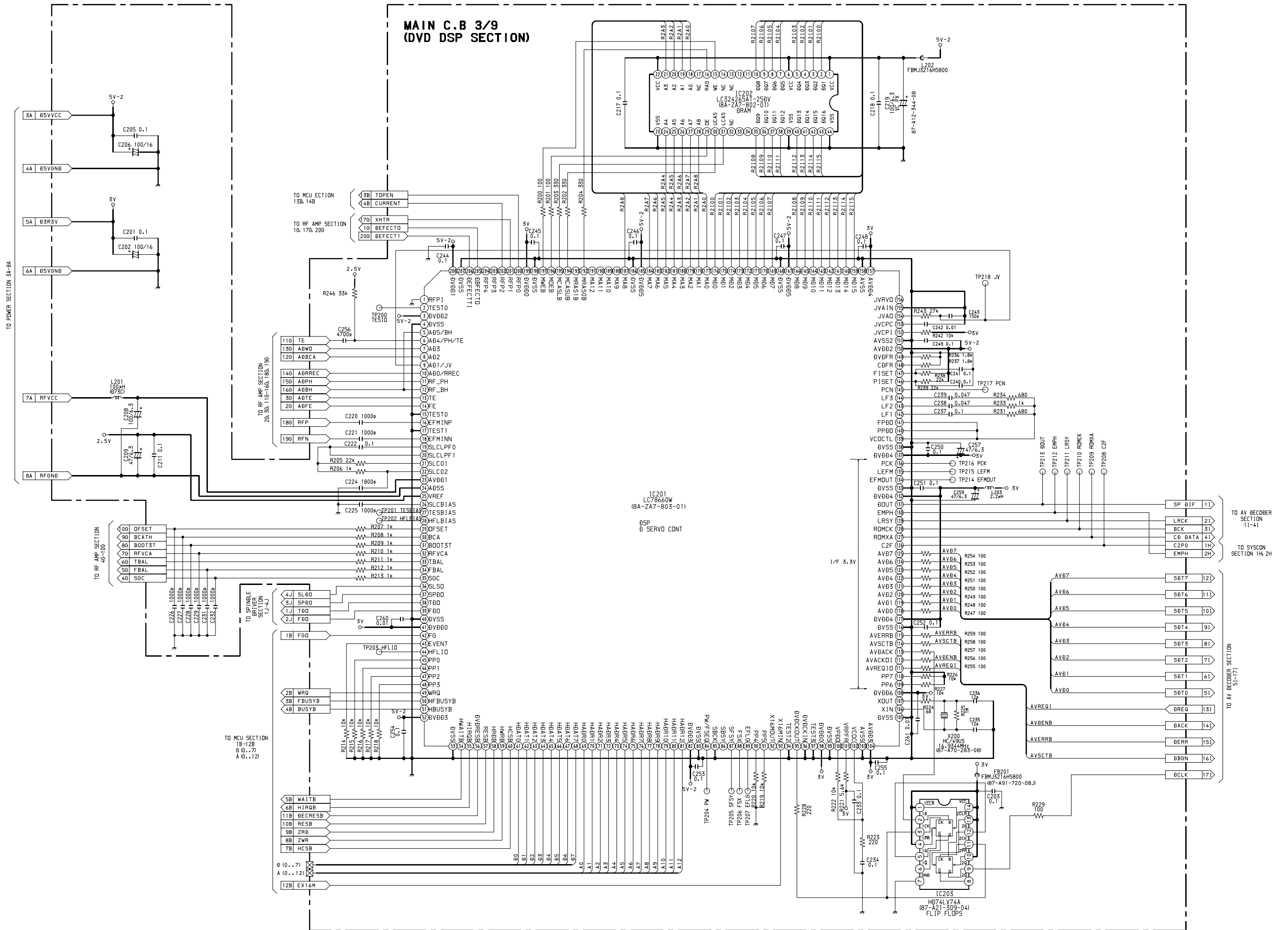

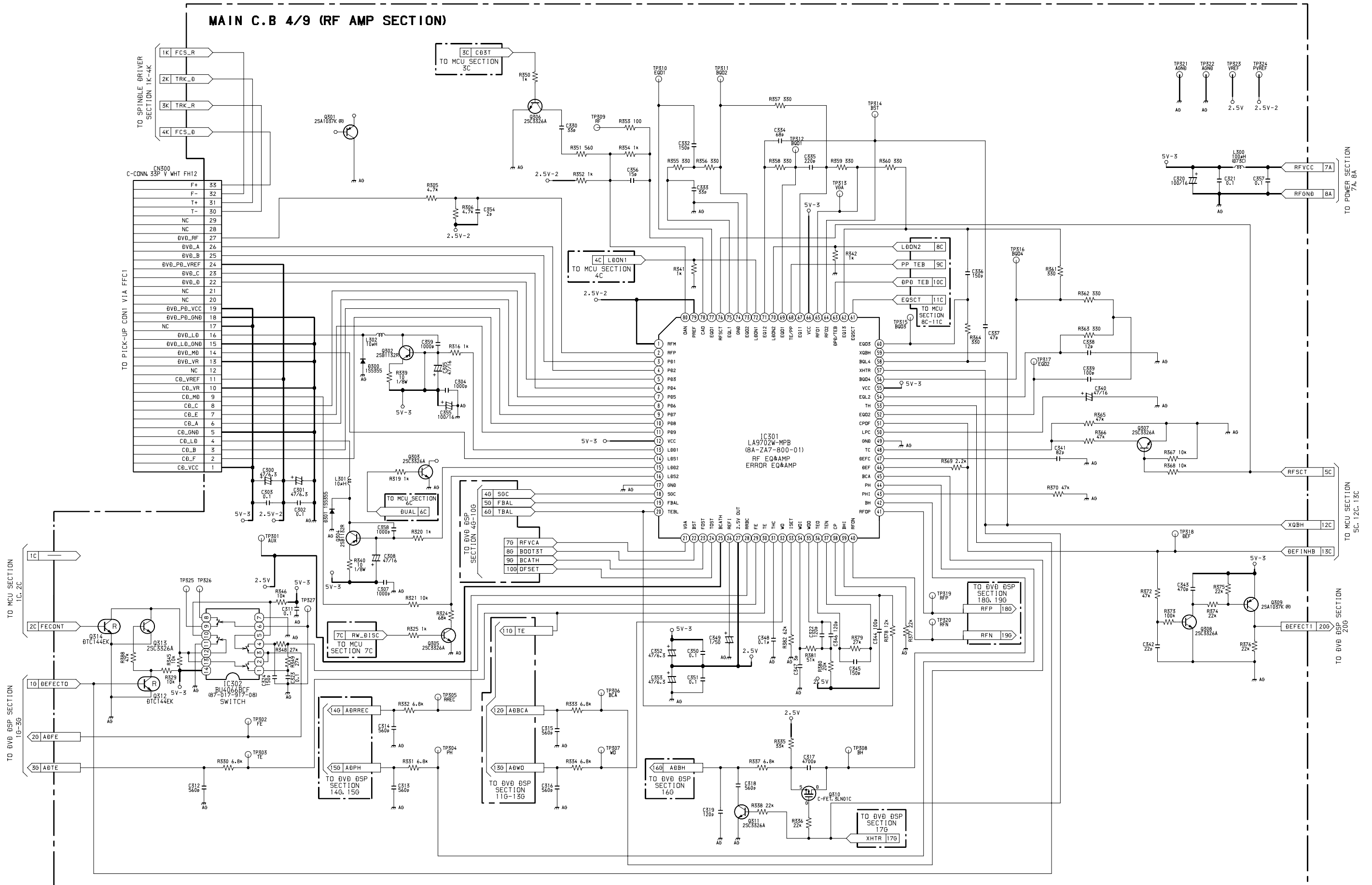

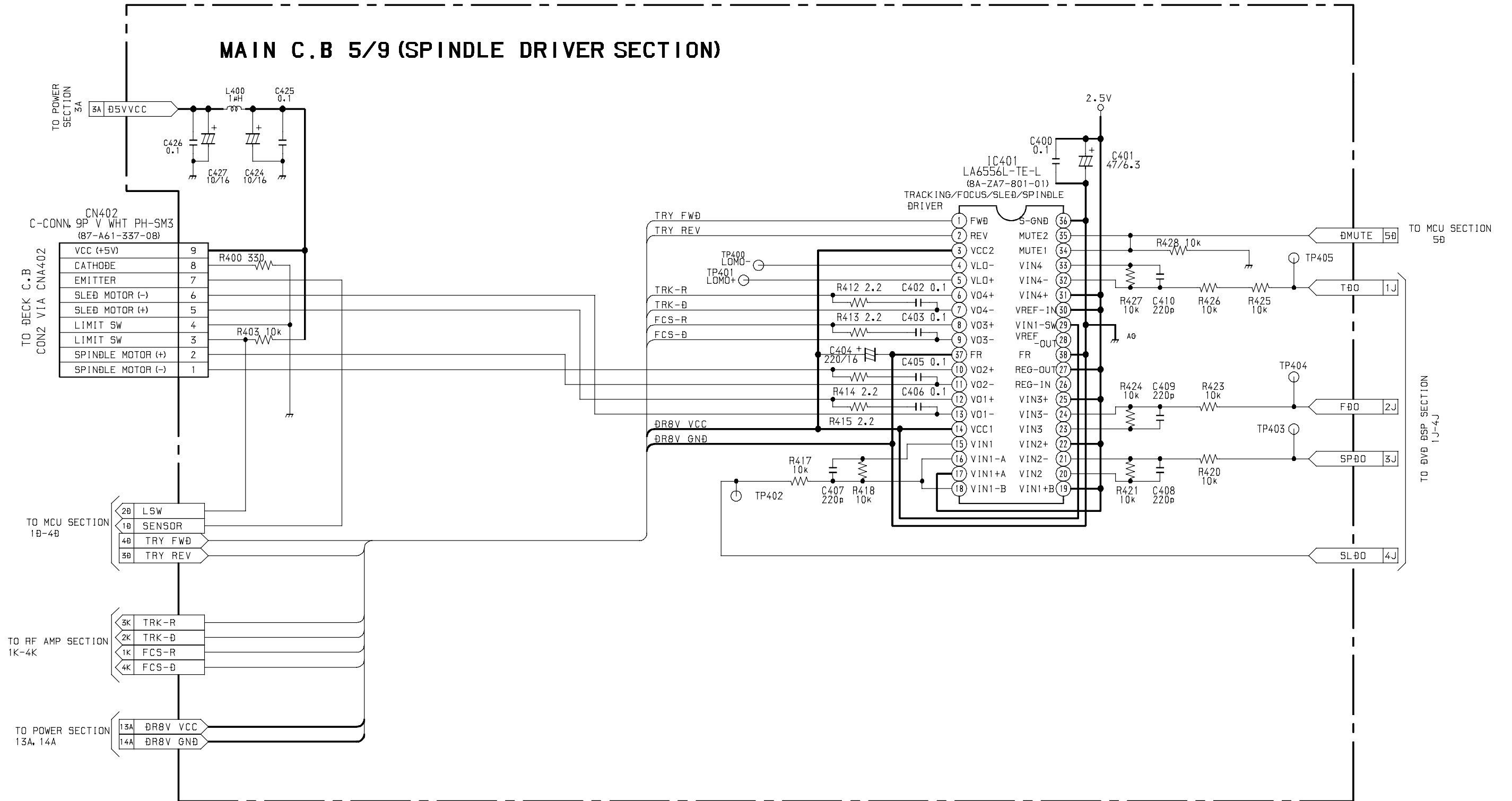

SCHEMATIC DIAGRAM - 7 (MAIN C.B 7/9)

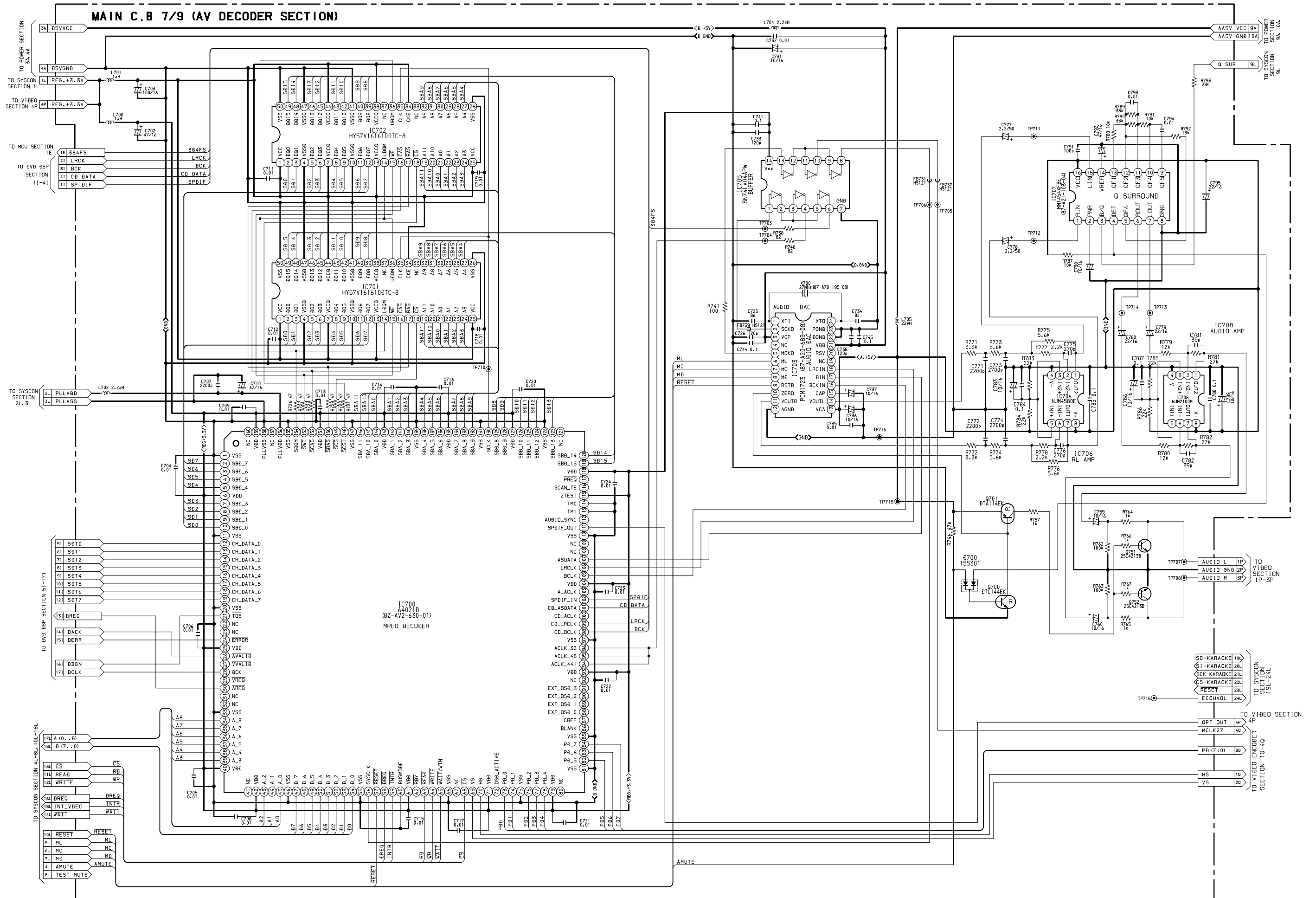

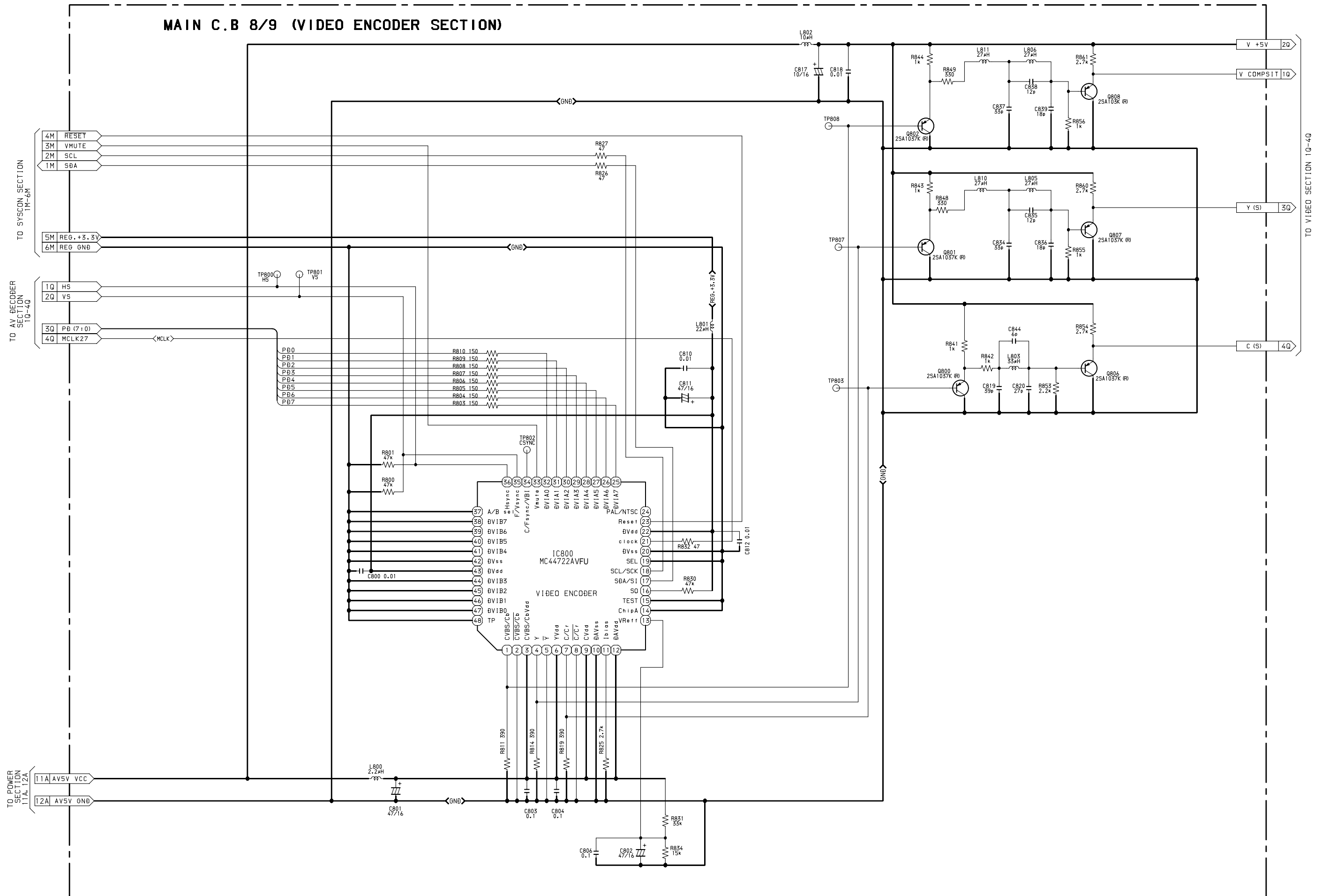

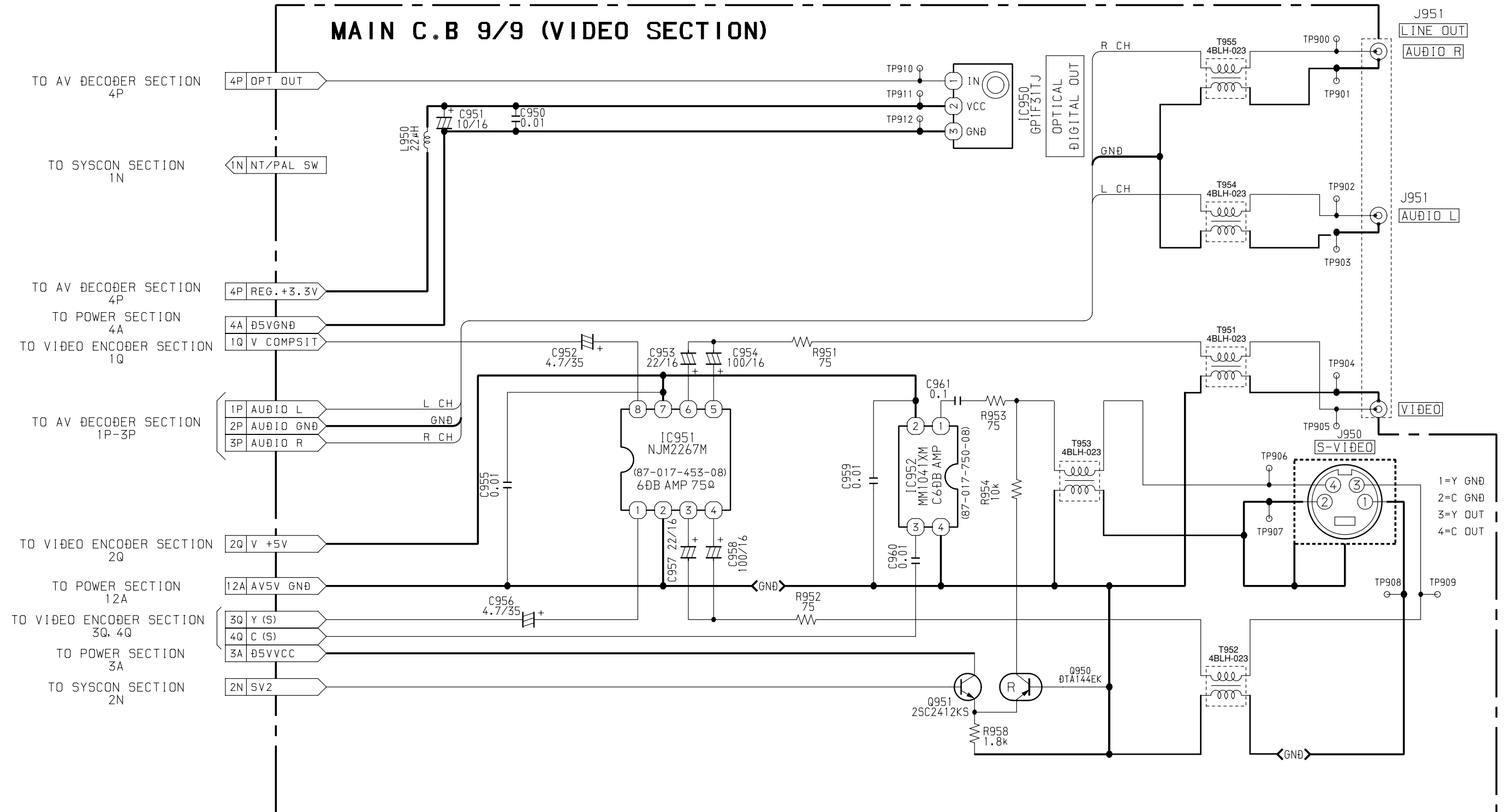

SCHEMATIC DIAGRAM - 11 (DVD MECHANISM SECTION)

PICK UP

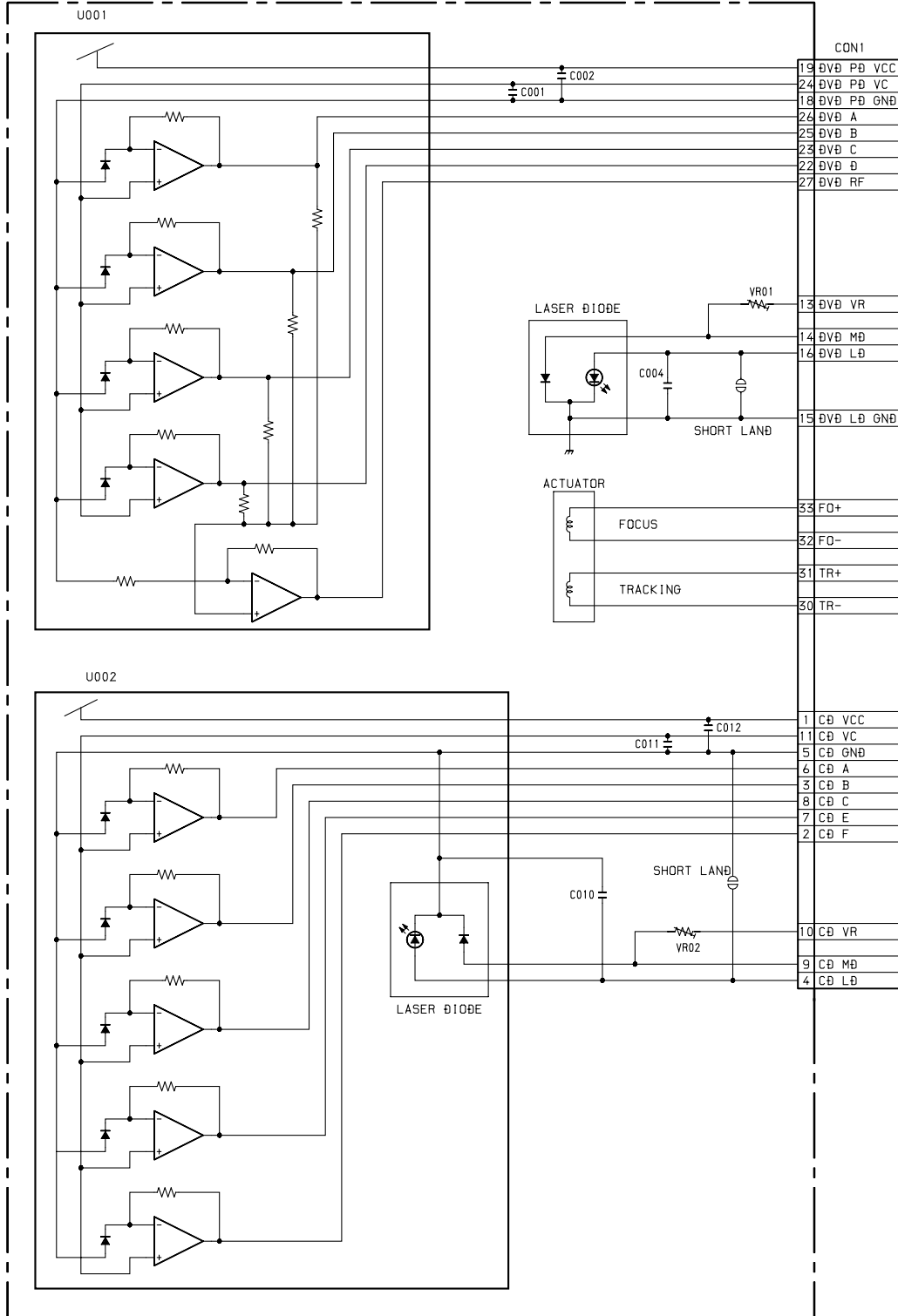

TO MAIN C.B 4/9
(RF AMP SECTION)
CN300
VIA FFC1

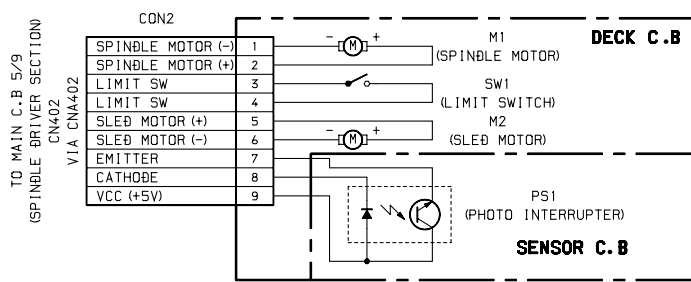

MECHANICAL MAIN PARTS LIST 1/1

REF. NO	PART NO.	KANRI NO.	DESCRIPTION
1	8A-AV6-007-010		WINDOW, LID
2	8A-AV6-005-110		LID, DISK
3	8A-AV6-001-010		CABI, TOP
4	8A-AV6-216-010		SPR-T, LID 2<HR(S), LH(S)>
4	8A-AV6-205-010		SPR-T, LID<K(S), Z(S)>
5	87-036-389-010		SW, PUSH 1-1-1 R8120125
6	87-063-164-010		OIL-DMPR,
7	8A-AV6-006-010		WINDOW, LCD
8	8A-AV6-003-010		CABI, FRONT<EXCEPT HR(S)>
8	8A-AV6-011-010		CABI, FRONT HR<HR(S)>
9	8A-AV6-008-010		BADGE, AIWA 25 SIL
10	8A-AV6-009-010		KEY, POWER
11	8A-AV6-608-010		LCD, AAV-6
12	8A-AV6-010-010		KEY, PLAY
13	8A-AV6-012-010		KEY, ENTER
14	8A-AV6-202-010		LENS, LCD
15	8A-AV6-201-010		HLD, LCD
16	8A-AV6-002-010		CABI, CNTR<LH(S)>
16	8A-AV6-013-010		CABI, CNTR W/SW<EXCEPT LH(S)>
17	8A-AV6-014-010		CABI, BTM HR<HR(S)>
17	8A-AV6-020-010		CABI, BTM LH<LH(S)>
17	8A-AV6-018-110		CABI, BTM K<K(S)>
17	8A-AV6-019-110		CABI, BTM EZ<Z(S)>
18	8A-AV6-215-010		FOOT, 19-1.5
19	87-A91-554-010		COVER, 2-44P IC179-44600
20	87-HC4-014-010		COVER, OPT
21	8A-AV6-299-010		MECHA, DVDTEMP
A	8A-ZG1-201-010		S-SCREW, MECH 880
B	87-067-581-010		TAPPING SCREW, BVT2+3-15
C	87-B10-307-010		VFT2+2.6-12 W/O SLOT<K(S), Z(S)>

COLOR NAME TABLE

Basic color symbol	Color	Basic color symbol	Color	Basic color symbol	Color
B	Black	C	Cream	D	Orange
G	Green	H	Gray	L	Blue
LT	Transparent Blue	N	Gold	P	Pink
R	Red	S	Silver	ST	Titan Silver
T	Brown	V	Violet	W	White
WT	Transparent White	Y	Yellow	YT	Transparent Yellow
LM	Metallic Blue	LL	Light Blue	GT	Transparent Green
LD	Dark Blue	DT	Transparent Orange	GM	Metallic Green
YM	Metallic Yellow	DM	Metallic Orange	PT	Transparent Pink
LA	Aqua Blue	GL	Light Green		

アイワ株式会社 〒110-8710 東京都台東区池之端1-2-11 ☎03(3827)3111 (代表)
AIWA CO.,LTD. 2-11, IKENOHATA 1-CHOME, TAITO-KU, TOKYO 110-8710, JAPAN TEL:03(3827)3111